

Courses & ea up y^e Creek
 N 15 W 14
 N 28 W 26
 N 44 W 24
 N 15 W 56
 North 38
 West 58
 S 56 1/2 W 27 1/2
 N 72 W 16
 N 42 W 14
 N 64 W 13
 West 29
 S 88 W 27
 S 75 W 1 1/2
 S 9 W 18
 S 57 W 55

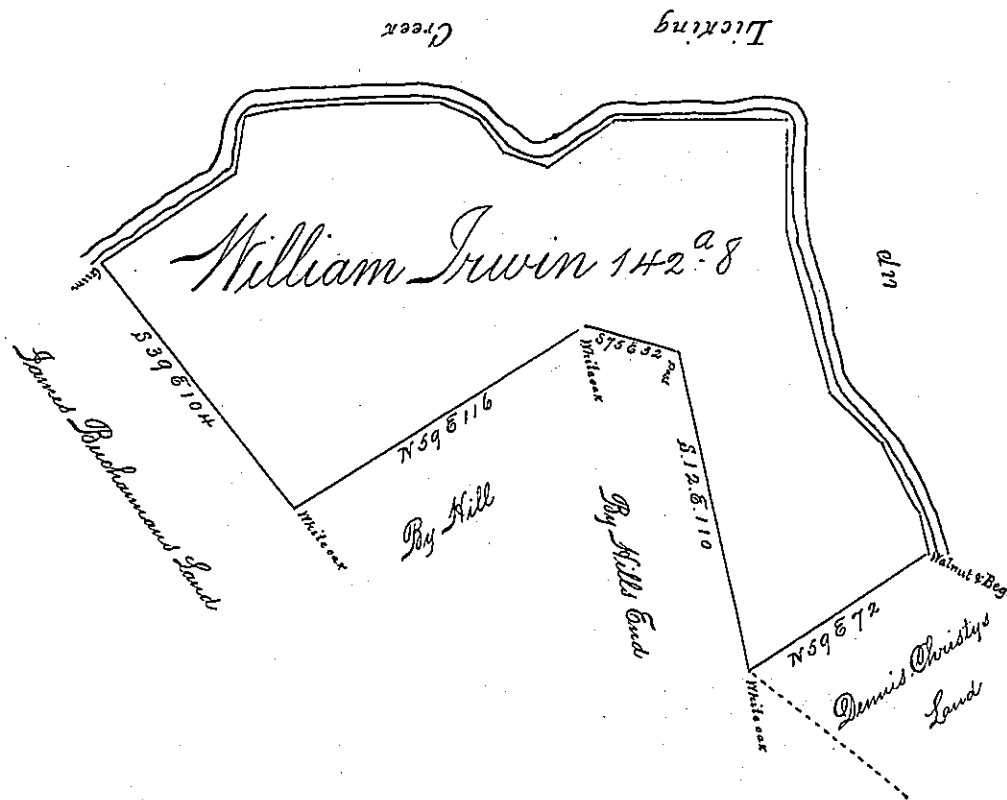

The Draught of a Tract of Land called _____ situate in Lick Township
 in Cumberland County containing one Hundred and Forty Acres and one Hundred
 and Forty perches with the usual allowance of Six acres per Cent for Roads &c. Surveyed
 the 24th Day of July Anno Domini 1767 In pursuance of an Order of Survey To
 William Irwin bearing Date at Philadelphia the 30th Day of March Anno Domini 1767
 and Numbered 3261.

Wm Macclay

To John Lukens Esq^r S. G.
 of Pennsylvania }

IN TESTIMONY that the above is a copy of the original remaining on file in the Department of
 Internal Affairs of Pennsylvania, made conformably to an Act of Assembly
 approved the 16th day of February, 1833, I have hereunto set my Hand
 and caused the Seal of said Department to be affixed at Harrisburg, this

fourth day of May 1897.

James W. Patton
 Secretary of Internal Affairs.